

Kitscape gardens:

**long-lasting
portable
durable
galvanised
metal edging**

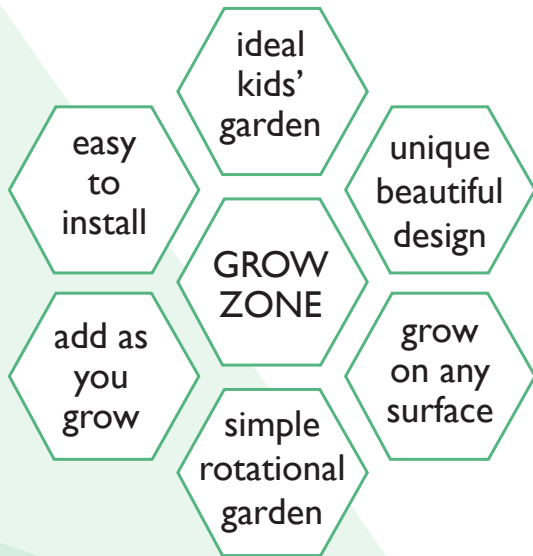

ideal for:

**backyards
school gardens
community gardens
roof gardens
& the workplace**

Making gardening easy and joyful for everyone!

Design your own DIY Beehive™ Grow Zone to create a modular and expandable vegetable or herb garden.

The Beehive™ Grow Zone is available in various height profiles of 185mm, 230mm and 290mm, cells are also available as a pre-bent 390mm and 580mm heights. The lower height profiles (up to 290mm) are best used as 'Dig' gardens on existing lawns or your garden area. The higher profiles (290mm-580mm) are best used as 'No Dig' gardens and can be installed on any surface you choose, whether it be lawn, concrete, paving, decking or rooftop. Ensure there is good sunlight, & appropriate conditions for your climate.

The FormBoss™ metal edging is simple to use. Try our Beehive Star™ designs, by creating triangles using 60° bends. Simply bend Kitscape's pre-marked lengths and join together with supplied connectors.

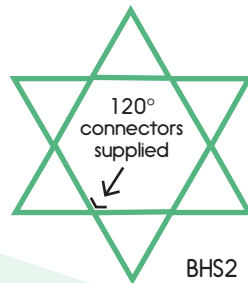
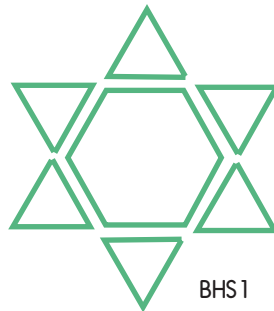

Follow these simple steps to create each kit-form garden bed:

You will need an electric or cordless drill with a tech screw bit and a block of wood.

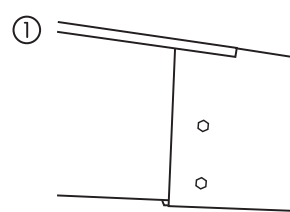

Attach connectors to the same end of each of the FormBoss™ lengths using the self-drilling metal tech screws supplied.

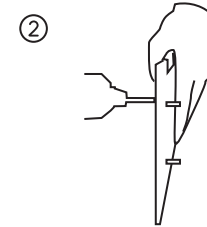

Drill screws approx. 40mm up from bottom & 150mm down from top. Note: 185mm profiles, connect on bottom only.

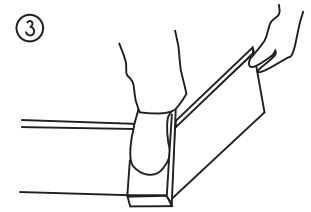

Lay each FormBoss™ length on a flat surface, with the flat side face down. Place a piece of timber along the pre-marked lengths, at each end and bend upwards.

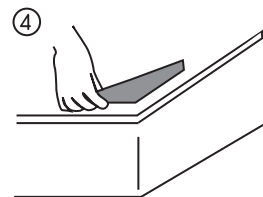

Using the supplied 120° template, adjust angles on each bend accordingly.

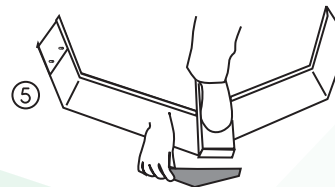

Bend centre crease on each of the FormBoss™ lengths, in the same way.

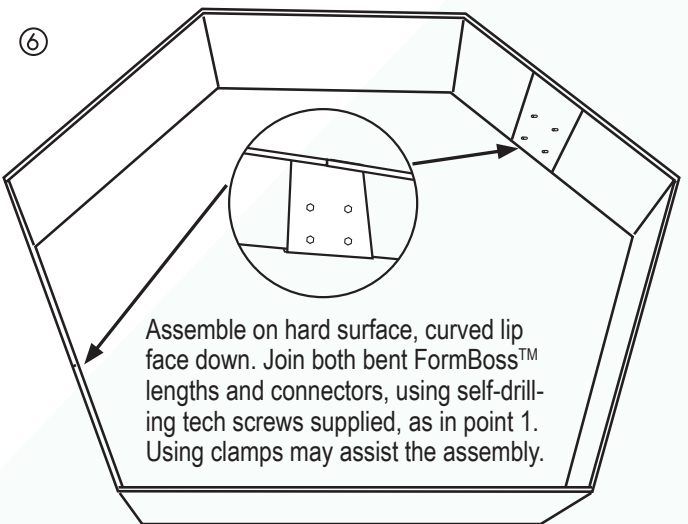

Assemble on hard surface, curved lip face down. Join both bent FormBoss™ lengths and connectors, using self-drilling tech screws supplied, as in point 1. Using clamps may assist the assembly.

For orders, installation & product advice contact **Greenlines Gardenware** on

Phone: 1300 307 542

Email: kitscape@greenlines.com.au

DIY



BH1



BH3



BH4



BH3

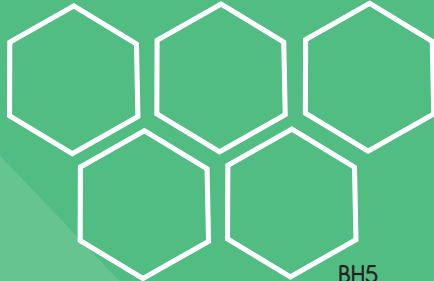

BH5

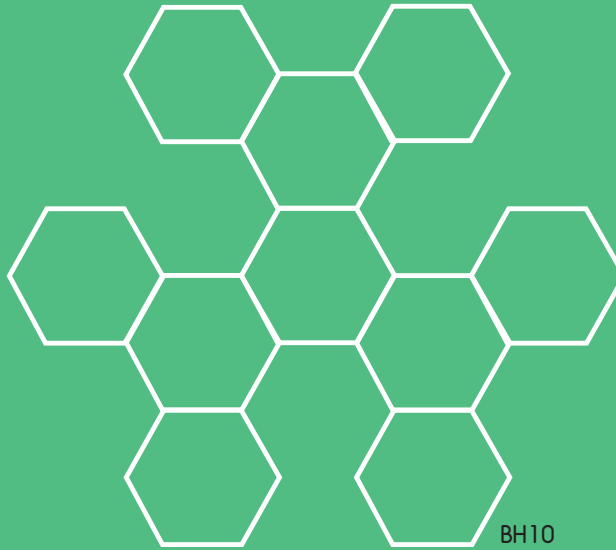

BH10



BH7

it starts with one cell, you design the rest...



Beehive™

Grow Zone



Modular & Expandable
Raised Garden Beds

For orders, installation & product advice
contact Greenlines Gardenware on

Phone: 1300 307 542

Email: kitscape@greenlines.com.au



Kitscape™

kitscape.com.au

*Making gardening easy
and joyful for everyone!*

kitscape.com.au